

How do I...

find how a variable was asked in the original questionnaire?

- a.k.a. source question and wider questionnaire
- e.g. “how do I find the questions used to measure alcohol intake in the CLOSER studies?”

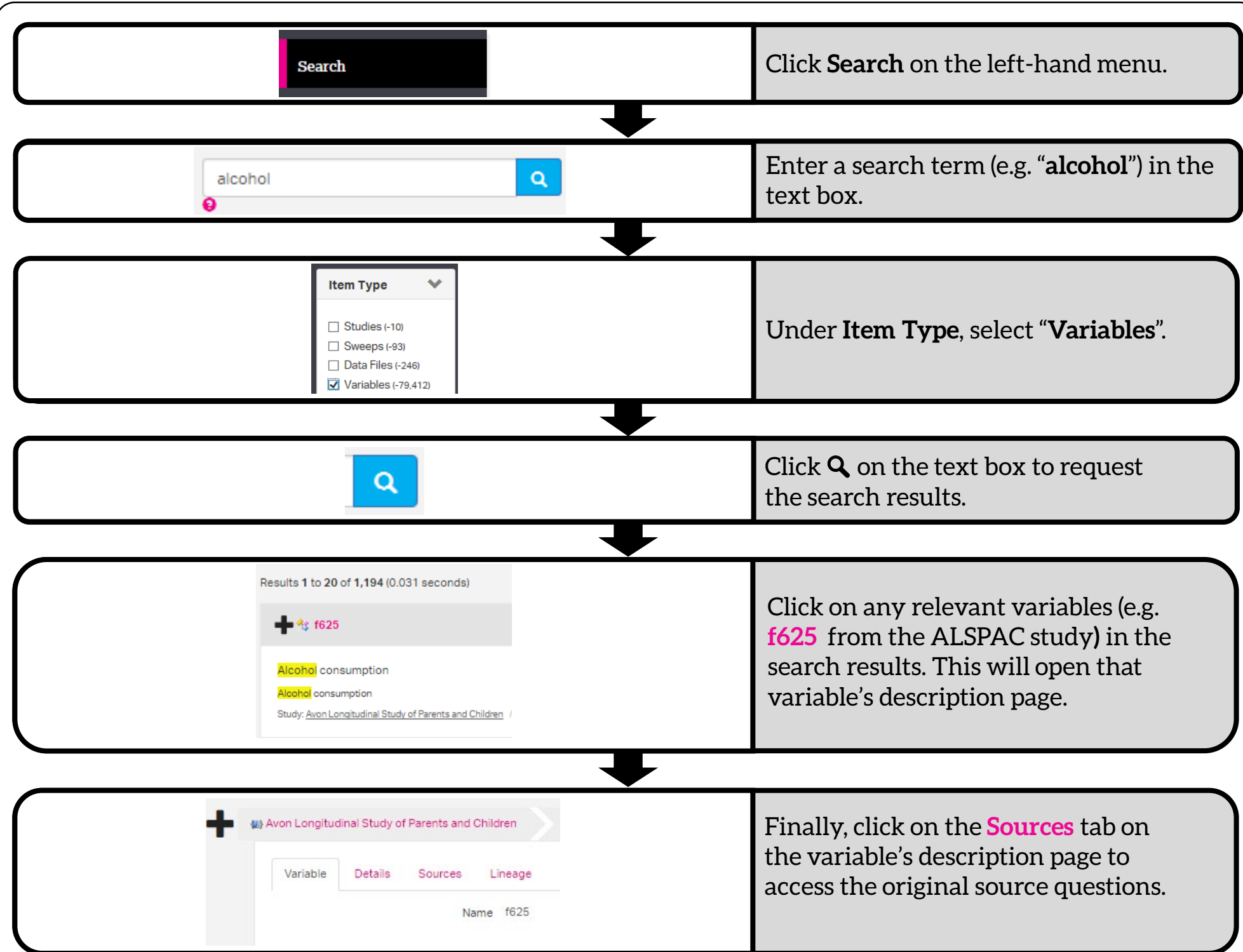

Results

Variable Details Sources Lineage

Source Questions

H2 a

Looking After the Baby

264 questions before...

H1 How many cigarettes per day do you currently smoke?

H2 a How would you describe your alcohol drinking? Which of the following statements best applies:

0	Never drink alcohol
1	Very occasionally (less than one glass a week)
2	Occasionally (at least once or twice a week)
3	Sometimes (between 3 & 6 times a week)
4	Drink 1-2 glasses every day
5	Drink 3-9 glasses every day
6	Drink at least 10 glasses a day
9	Don't know

[by glass we mean pub measures (1oz) of spirits or 1/2 pints of beer or cider]

117 questions after...

View the complete instrument Looking After the Baby

Source question name

Neighbouring questionnaire content

Source question

Response options (codes and labels)

Neighbouring questionnaire content

Access the full set of questions (including a PDF scan of the original questionnaire)